



The Phrase Maker

ICONS & NUMBERS

The Icons and Numbers Phrase Maker with unique Color Ink and Designer Labels allows you to print customized words, phrases, numbers, punctuation and icons from pre-loaded design bars (months, days, numbers, family and general words, punctuation, messages and more!

INSTRUCTIONS

TO LOAD OR CHANGE DESIGNER LABELS

1. Hold tool as shown in photo #1. Place finger on top of clear cover, press down gently and pull outward to open label roll cover.
2. Using finger and thumb, open base plate by pulling back on knobs on either side of tool.
3. Straighten out about 10" of labels and feed through open space inside of tool starting at the top. When you see end come through the bottom, hold on to it. Place label spool on the wide black peg holder and close the clear cover.
4. Turn tool over, grasping labels, pull until approx. 10 labels are in view. Lay labels forward and close first label door pushing forward.
5. Pull labels back over first base plate door toward you so they lay on top of the feed roller pins. Line label slits or holes over the feed roller pins.
6. Hold in place and close plate cover. Squeeze and release handle 3-4 times to advance the labels. The labels will self-center after a few clicks.

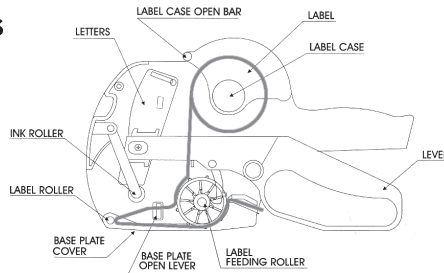

TO PRINT A LABEL

1. Select the letters or icons by looking in the top window (with the handle pointed toward you) while turning the knob. The space on the right is where you will place the first letter of your word. Work to the left for following letters. There are 8 character spaces for each label. If your word is longer, make an additional label - they line right up!

VERY IMPORTANT: Follow the enclosed Key to see which character will print. A regular price gun has 13 characters on the rubber stamp. Our Phrase Maker has 26! That means we utilized all of the spaces on the stamp inside. So, what you see in the window on top is opposite to what character will print below. This is why using the key is so important to spelling your word.

TO MAKE A BLANK SPACE: Turn the knob until a yellow square is on top.

TO CENTER A WORD ON THE LABEL:

Count how many characters are in your word. There are 8 character spaces. If your word has 4 letters, to center, select 2 blank spaces (or yellow squares) before and after your word.

2. Now that you have your characters selected, squeeze the hand trigger to print the label. The harder you squeeze, the bolder the ink. The label will eject from the end of the tool.

3. To place the label on your project, tip the tool down toward the surface (while watching) and gauge where you want the label to land. Pull the tool toward yourself while applying slight pressure. Label may also be hand applied after removing it from the end of the tool. Repeat!

NOTE: Wait a minute and check to be sure ink is dry before touching to prevent smearing.

KIT CONTENTS

- 1 Icons & Numbers Phrase Maker Tool with Wrist Cord (Size: 9"L x 4-1/2"H x 1-5/8"W)
- 5 Interchangeable, Non-Toxic Ink Cartridges (2 Black - one is loaded in tool, Purple, Blue and Red)
- 10 Rolls of Labels in a variety of solid pastel colors and designs. Label size: 13/16" x 1/2" Approx. 5,500 labels total.

PRESS DOWN AND PULL OUTWARD



STRAIGHTEN AND INSERT LABELS INTO CHAMBER, GRASP END AND PULL THROUGH

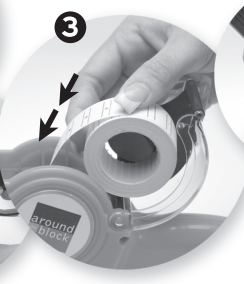

LAY LABELS FORWARD AND CLOSE FIRST BASE PLATE



LINE UP LABELS OVER THE FEED ROLLER PINS



CLOSE BASE PLATE COVER

PRESS DOWN AND TILT OUT TO OPEN

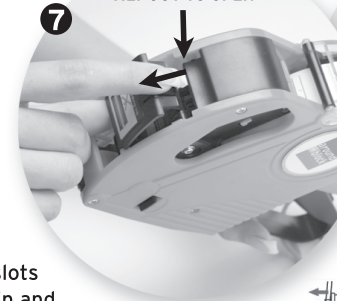

8

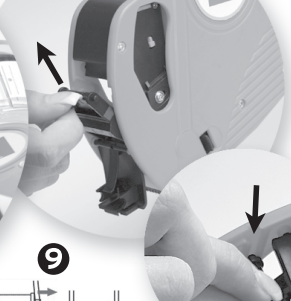

9

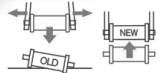

LOOK FOR AND ALIGN IN SLOTS

10



TO LOAD OR CHANGE INK

7. Press on the ink cartridge door grip, and tilt outward to open.
8. The ink cartridge has a little handle, grip and pull this up and out to remove, taking note the slots that the cartridge slides in and out of. You will replace the cartridge in the same slots in step 10.
9. Change the ink pad by gently pulling cartridge ends outward. Be gentle, with too much pressure, the pegs could break.
10. With the ink roller going in first, and the cartridge handle pointing outward, align pegs of cartridge into slots. It will slide in easily if you have it lined up correctly. Close door.

NOTES:

- Take care when changing ink, protect surfaces and clothing to avoid staining.
- Ink easily washes off with soap and water.
- Ink is NON TOXIC.
- To prevent extra ink from drying out, store in an airtight container.
- New ink rollers are available if your ink should happen to run out.

www.aroundtheblockproducts.com

© Around The Block, LLC. Layton, UT 84041
All rights reserved.

WARNING: NOT FOR CHILDREN.

Made in China